

Door Preparation Instructions for Door **with No Holes**

Schlage Encode™, BE489

Tools Needed

① If you are uncomfortable performing these steps, call a locksmith for assistance.

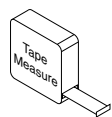

Tape Measure



Pencil

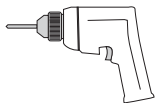

Drill and Drill Bits
Bit Sizes: 1/8", 1"

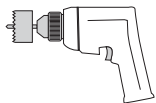

Hole Saws
1", 2 1/8"



Chisel



Hammer

1 Measure door thickness.

If the door is thinner than 1 3/8" or thicker than 1 3/4", then the lock will not fit properly on the door.

A thick door kit is used to fit the Schlage Encode to doors that are between 1 7/8" and 2 1/4" thick.

① A thick door kit is available from Product Support at (888) 805-9837

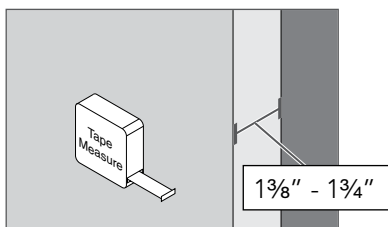

2 Mark door.

Mark lock centerline on door face, door edge and door jamb.

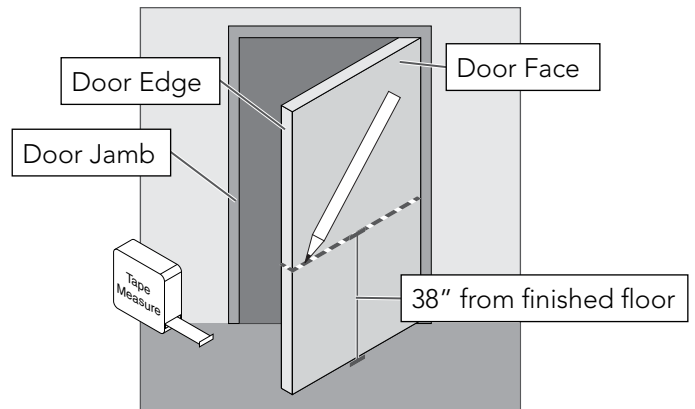

3 Prepare cross bore.

3a Measure backset and mark center of hole.

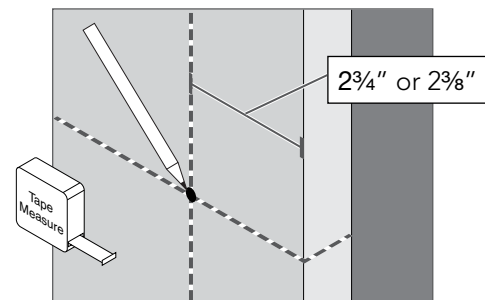

3b Drill hole with hole saw.

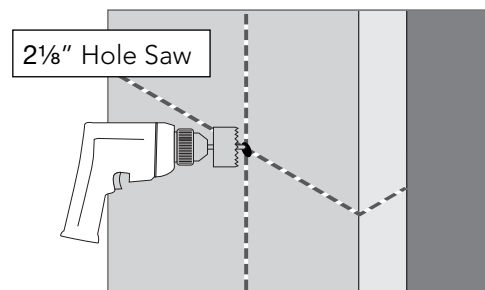

4 Prepare door edge hole.

4a Measure and mark 1/2 door thickness.

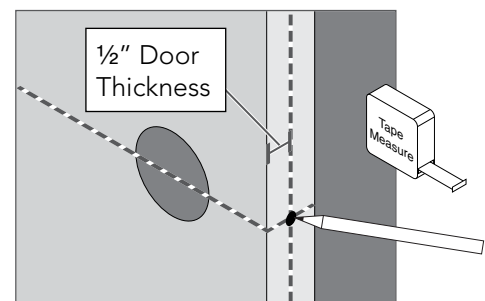

4b Drill hole in door edge.

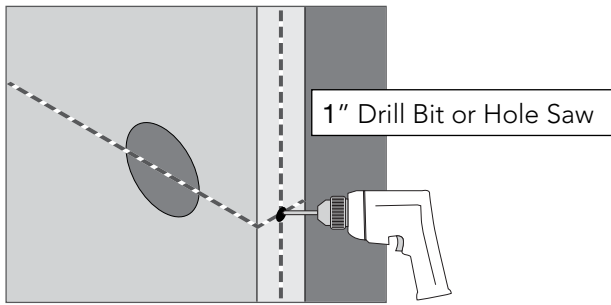

5 Mortise for bolt.

5a Insert bolt into door edge hole. Trace bolt faceplate and mark holes.

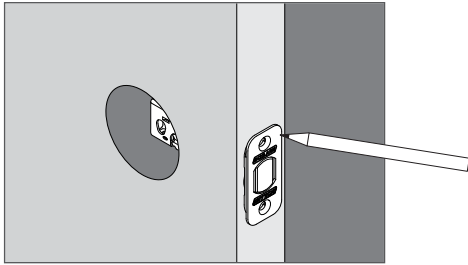

5b Remove bolt and drill two 1/8\"/>

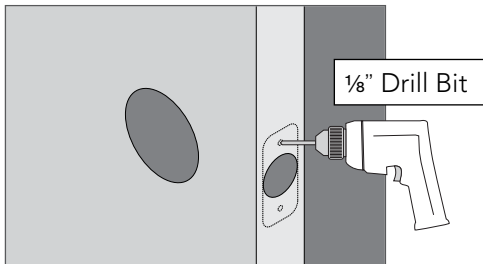

5c Use chisel and hammer to create bolt mortise.

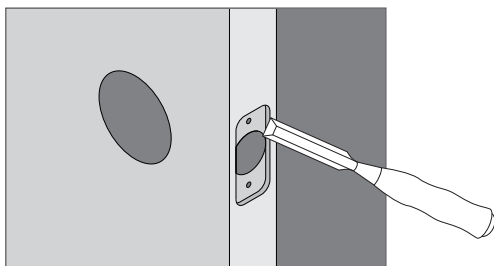

6 Measure, mark and drill holes in door jamb for strike.

6a Mark center for strike hole exactly opposite latch hole.

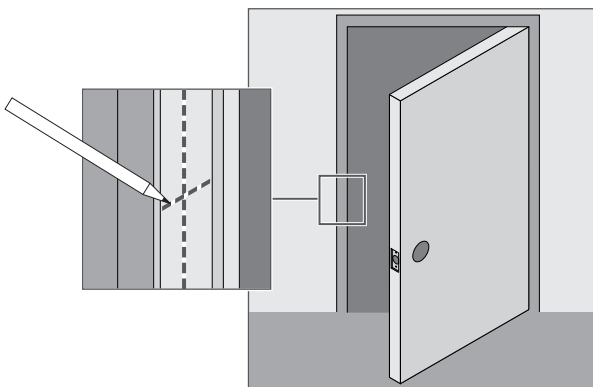

6b Measure, mark and drill two (2) 1\"/>

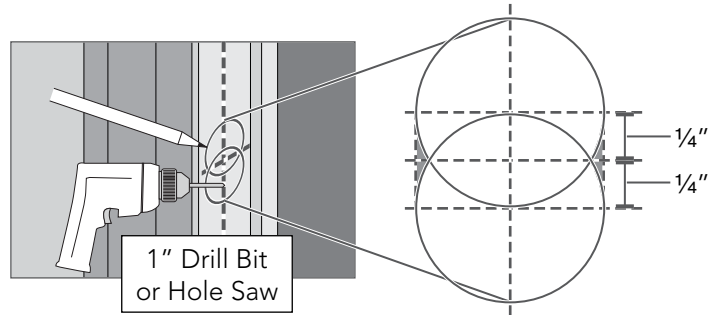

7 Mortise for strike and reinforcement plate.

7a Trace strike and reinforcement plate and mark holes.

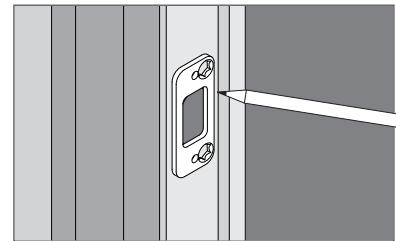

7b Drill four (4) 1/8\"/>

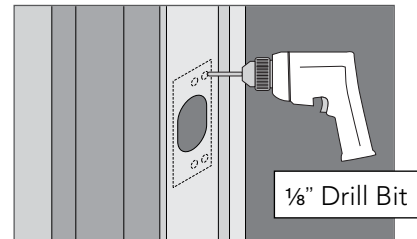

7c Use chisel and hammer to create mortise for strike and reinforcement plate.

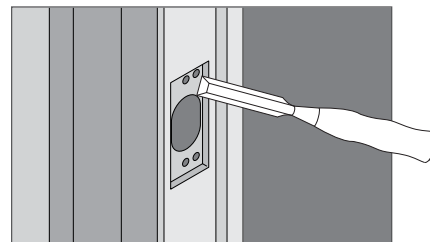

Questions about your new Schlage **Encode**™ Smart WiFi Deadbolt?

Please don't return it to the store!



Let us help you first!

www.schlage.com/faqs-encode

Schlage Customer Service
Calling From:
USA: (888) 805-9837
Canada: (800) 997-4734
México: 018005067866



© Allegion 2018
Schlage Encode door prep with no holes
Rev. 10/18-a